

AFL at Blundstone Arena - Bellerive 2021 Premiership Season

Dear Resident

There has been an update to the arrangements made for the 2021 AFL Season matches hosted by Bellerive Oval (Blundstone Arena). The updated details of the events are listed below with the inclusion of an additional match. Due to the crowds anticipated at these events, the Bellerive Oval Traffic Plan (BOTP) will be implemented to minimise the impact on local residents.

Event Details

Date	Format	Road Closure Time	Gates Opening (General Public)	Match Start Time	Match Expected Finish
19 June 2021	AFL	13:30	15:00	16:35	19:05
26 June 2021	AFL	10:45	12:15	13:45	16:15
*Friday, Jul 30 - Sunday, Aug 1	AFL	TBC	TBC	TBC	TBC

*Date and time to be confirmed closer to the match

Due to the crowds anticipated at these events, the Blundstone Arena Traffic Plan will be implemented to minimise the impact on local residents.

Road Closures

The following streets will be subject to road closures for general traffic on event day:

- Park Street (entire length between Scott and Derwent Streets)
- Church Street (entire length between Scott and Beach Streets)
- Derwent Street (between Douglas Street and the entrance to the beach car park)

Residents in these streets are allowed access as will DDA parking permit holders and service vehicles. Please see also the road closure map on the back of this notice.

Public Transport

The complimentary bus service from the city will again be in operation. This will assist in easing traffic and parking concerns in the Blundstone Arena - Bellerive precinct.

Parking

Free parking for patrons is being provided at the South Street reserve for events where significant crowds are expected. On-street parking restrictions will be put in place from 6am on match days.

The Parking Hotline will be established, if you are inconvenienced by inconsiderate on street parking near your house, please call the hotline on **03 6217 9589** to seek assistance.

Kind Regards

Andrew Brown (CCC) – 03 6217 9696

Jonathon Kearney (BAB) – (03) 6282 0409

Sean Hollick (Resident Representative) – 0409 463 769

Blundstone Arena – Bellerive

2021 AFL Match Day Road Closures

www.invarion.com

1773a - Blundstone

AFL Fixtures (2021) - Traffic Management Diagram

Radio Channel For Traffic Controllers: Channel No. 30

LEGEND

- Event Road Closure
- Traffic Controller
- Taxi Rank/ Route
- Uber Zone/ Route
- Bus Route
- Metro Drop off stop
- No Parking/ Stopping
- DDA, 5min, Drop off Pick up Area
- Accessible Parking
- 5min drop off/ pick up
- Police Parking Zone
- Team 'Coach' parking
- Metro Stage Area
- Traffic Cones/ Bollards
- Barrier Boards
- CCB

Crowd Control Barriers (CCBs) to assist with safety of Pedestrian movement. Prior to & after Event. Corner CCBs to be placed prior to start of Event and CCBs along Church Street to be placed during Event.

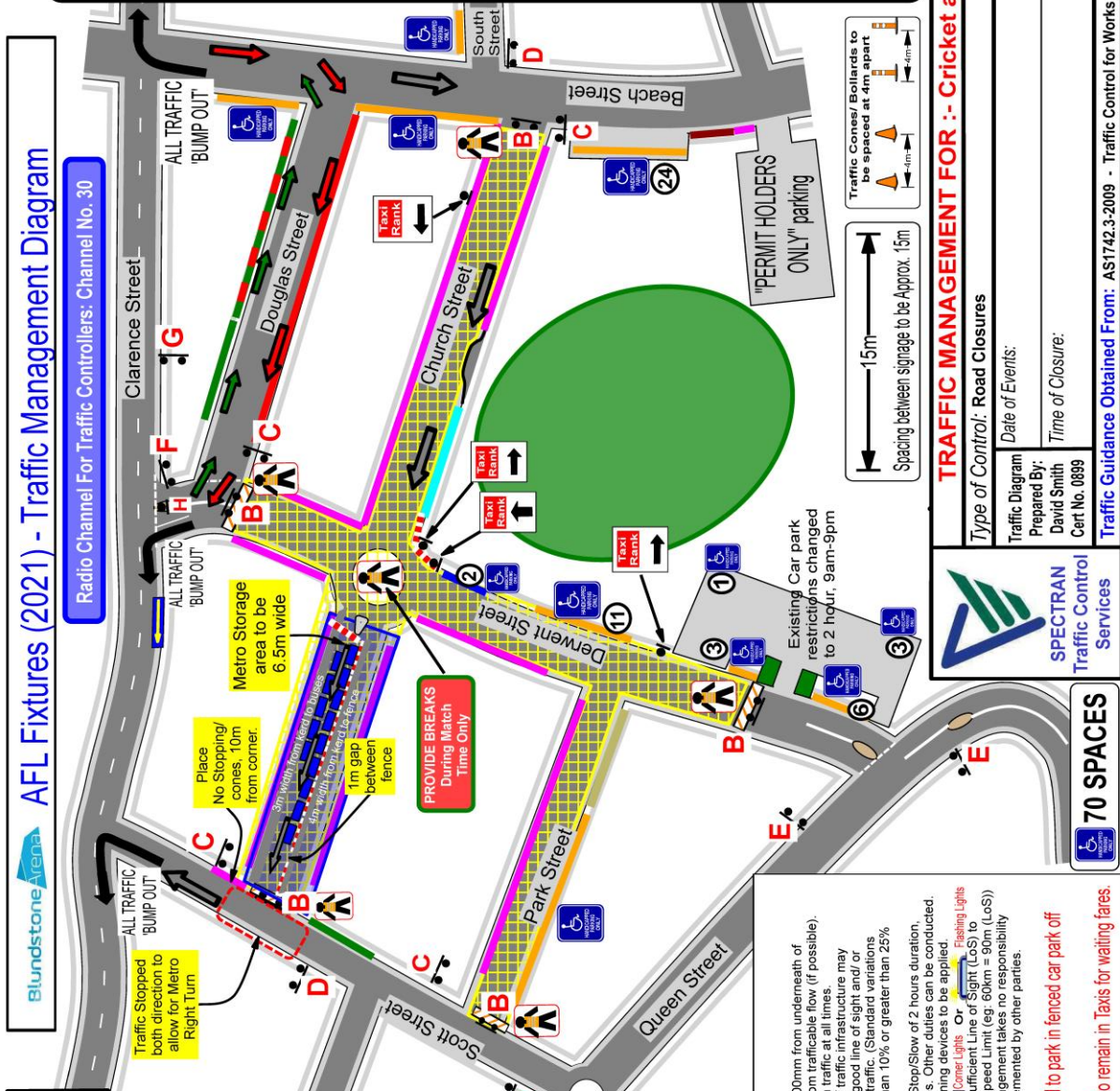

- KEY -

- B** x5 ROAD CLOSED
- C** x4 ROAD CLOSED ON SIDE ROAD
- D** x4 ROAD CLOSED ON SIDE ROAD
- E** x2 ROAD CLOSED ON SIDE ROAD
- F** x1 ROAD CLOSED AHEAD
- G** x1 PREPARE TO STOP
- H** x2 ONLY

NOTES

- All daily working signs to be 200mm from underneath of sign to ground level and 1m from trafficable flow (if possible).
- Min. 3.0m required for through traffic at all times.
- The position of and spacing of traffic infrastructure may slightly vary on-site to ensure good line of sight and/or effectiveness for approaching traffic. (Standard variations shall be used). E.G. Not less than 10% or greater than 25% of speed specified.
- Traffic Controller on constant Stop/Slow of 2 hours duration, must be relieved for 15 minutes. Other duties can be applied.
- Use of vehicular mounted warning devices to be applied.
- Traffic Controller to maintain Sufficient Line of Sight (LoS) to approaching vehicles. (1 X Speed Limit (eg. 60km = 90m (LoS))
- Speed Environmental Management takes no responsibility for use of this plan when implemented by other parties.
- Not to Scale
- Charter Buses to be directed to park in fenced car park off Pembroke Place.
- All Taxi drivers are required to remain in Taxis for waiting fares.

TRAFFIC MANAGEMENT FOR :- Cricket at Blundstone Arena

Type of Control: Road Closures

Date of Events:

Prepared By: David Smith

Time of Closure:

Cert No. 0899

TRAFFIC CONTROL SERVICES

Blundstone Arena

70 SPACES